

APPROVER'S NOTE
FILL PL THICKNESS SHOWN IN SHOP BILL IS THE THICKNESS OF MATERIAL ORDERED PRIOR TO FINISHING TO THE THICKEST DIM. REQUIRED.

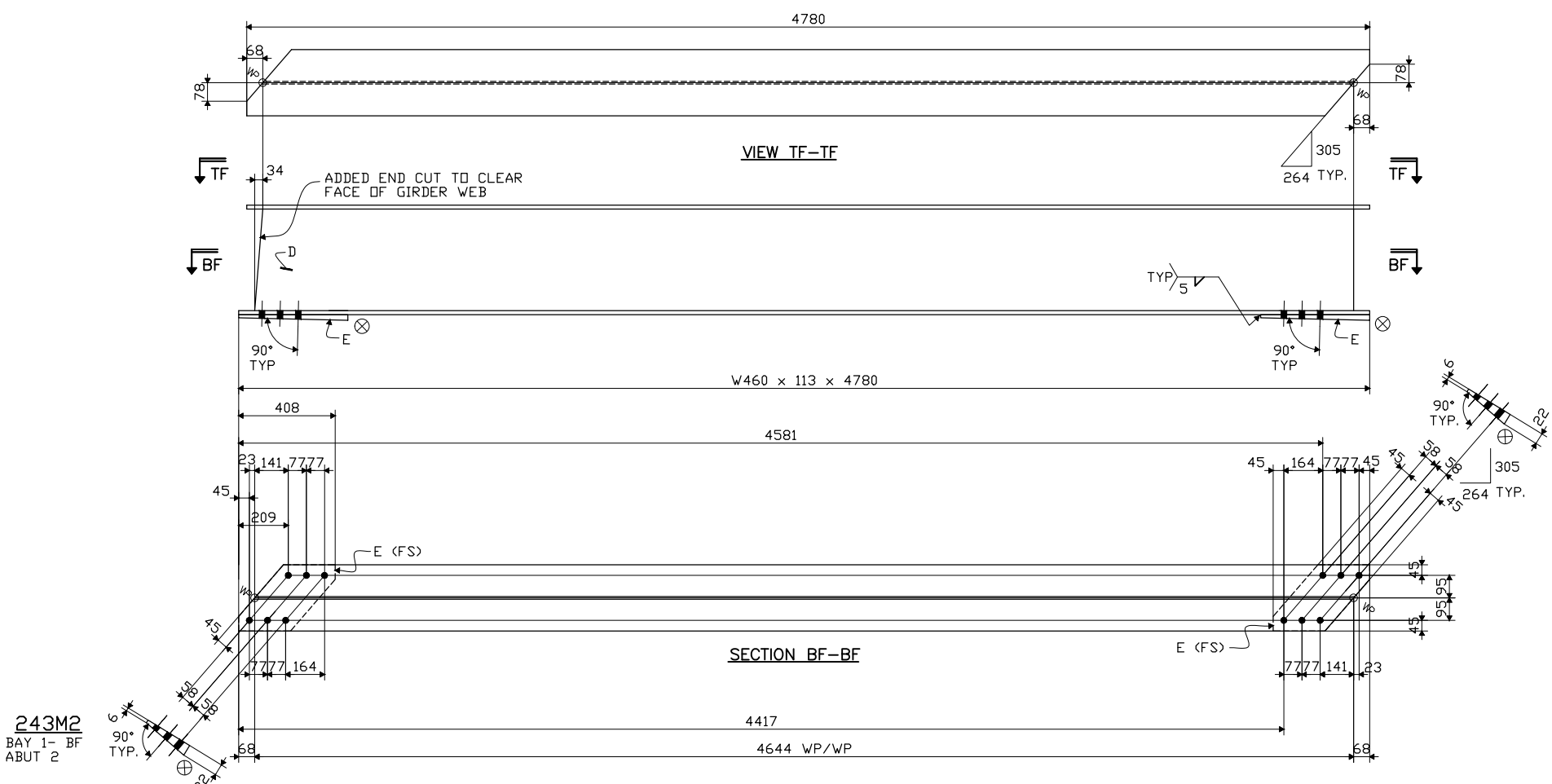

SHOP BILL

LINE NO.	SHIPPING LIST		REV.	DESCRIPTION			LENGTH	ASSEMBLY MARK	REMARKS	MTRL. SPEC.	MATERIAL APPLICATION			
	NO. PCS.	MARK		CODE	SYMBOL	SECTION DIM'S					mm	P.O. NO.	LINE ITEM NO.	NO. PCS.
1														
2														
3														
4	1	243M1			TOP LATERAL BRACING									
5			1	W	460 x 113	4812	A	V	A709M-250	7118NY	1			
6			2	PL	12 x 280	411	C	V	A709M-250	7116IS	5			
7														
8														
9														
10														
11	1	243M2			BOTTOM LATERAL BRACING									
12			1	W	460 x 113	4780	D	V	A709M-250	7118NY	1			
13			2	PL	12 x 280	408	E	V	A709M-250	7116IS	5			
14														
15														
16														
17														
18														
19														
20														
21														
22														
23														
24														
25	DOMESTIC MATERIAL													
SEE HN201 FOR FABRICATION NOTES														

PDC Sample DWG 302
 LOUDOUN CO, TN
 HIRSCHFELD INDUSTRIES
 CHARLES BLALOCK AND SONS
Lateral Member Detail
 TNDOT 2012

FABRICATED BY COLFAX

HOLES 27 Ø SHOP FASTENERS

SHOP PAINT PAINTED PER HN201

SHOP INSPECTION

GENERAL NOTES

REVISIONS		
DATE	NO.	BY
01/28/13	R1	PDC/WS
12/19/13	R2	PDC/SB
10/31/14	R3	PDC/WS
11/14/14	R4	PDC/SB

PROJECT No. NH-73(50)
 CONST. No. 53008-3233-14
 BRIDGE I.D. No. 53SR0950009

ORDER NO. 12-18779H32
 DETAILS OF LATERAL BRACING DETAIL

PROJECT SR 73 OVER TELLICD CANAL AND STATE ROUTE 444 (STA: 3+757.570)

LOCATION LOUDOUN COUNTY, TN
 CUSTOMER CHARLES BLALOCK AND SONS

HIRSCHFELD INDUSTRIES BRIDGE
 GREENSBORO, NC (336) 275-9711

MADE BY WS
 CHECKED BY PDC/SB
 SOUND LEADER: Precise Drafting Co, Inc.
 DATE 07-12

SHIRT HF243